

**BOARD OF SUPERVISORS, COUNTY OF HUMBOLDT, STATE OF CALIFORNIA**

Certified copy of portion of proceedings, Meeting of January 18, 1983

RESOLUTION NO. 83-20

ESTABLISHING GARBERVILLE UNDERGROUND  
UTILITY DISTRICT NO. I

WHEREAS, pursuant to notice duly given, a public hearing was called for January 18, 1983, at 1:45 p.m., in the Supervisors' Chambers in the Humboldt County Courthouse, Eureka, California, to ascertain whether the public necessity, health, safety, or welfare requires the removal of poles, overhead wires and associated overhead structures, and the underground installation of wires and facilities for supplying electric, communication, or similar or associated service, within that certain area of the County described as follows: along a narrow corridor on each side of and running along Redwood Drive from where Conger Street intersects it to its southerly terminus, and along Sprowel Creek Road from where it intersects Redwood Drive to the east side of the U.S. 101 Freeway Overcrossing; and

WHEREAS, notice of said hearing was given as required by law; and

WHEREAS, a public hearing was held on the date and at the place described in the notice referred to above, and interested persons were given an opportunity to be heard;

NOW, THEREFORE, the Board of Supervisors of the County of Humboldt finds, declares, and resolves as follows:

1. The public necessity, health, safety and welfare requires the removal of poles, overhead wires and associated overhead structures, and the underground installation of wires and facilities for

1/ 2  
**BOARD OF SUPERVISORS, COUNTY OF HUMBOLDT, STATE OF CALIFORNIA**

Certified copy of portion of proceedings, Meeting of January 18, 1983

supplying electric, communication and similar associated services within that certain area of the County referred to above and in Paragraph 2, below.

2. Pursuant to Sections 361-1 through 361-15 of the Humboldt County Code, the area described above and in this paragraph is hereby declared an underground utility district and is designated as "Garberville Underground Utility District No. I". Attached hereto, marked "Exhibit A," and hereby incorporated as a part of this resolution, is a map and legal description delineating the boundaries of said District.

3. April 1, 1984, is hereby fixed as the date on which affected property owners must be ready to receive underground service, and this Board hereby orders the removal of all poles, overhead wires and associated overhead structures and the underground installation of wires and facilities for supplying electric, communication, or similar or associated service within Garberville Underground Utility District No. I on or before June 1, 1984.

4. The Clerk of the Board is directed to notify all affected utilities and all persons owning real property within Garberville Underground Utility District No. I of the adoption of this resolution within ten (10) days after the date of such adoption. Said Clerk of the Board shall further notify said property owners of the necessity that, if they or any person occupying such property desire to continue to receive electric, communication, or other similar or associated service, they or such occupant shall, by the date fixed in this resolution, provide all necessary facility changes on their

**BOARD OF SUPERVISORS, COUNTY OF HUMBOLDT, STATE OF CALIFORNIA**

Certified copy of portion of proceedings, Meeting of January 18, 1983

premises so as to receive such services from the lines of the supplying utility or utilities at a new location, subject to applicable rules, regulations, and tariffs of the respective utility or utilities on file with the Public Utilities Commission of the State of California. Such notification shall be made by mailing a copy of this resolution, together with a copy of Sections 361-1 through 361-15 of the Humboldt County Code to all affected property owners as shown on the last equalized assessment roll and to the affected utilities.

5. The Garberville Underground Utility District No. I herein created is in the general public interest for the following reasons:

a. The undergrounding to be accomplished will avoid or eliminate an unusually heavy concentration of overhead distribution facilities; and

b. The streets, roads, or rights of way in the District are extensively used by the general public and carry a heavy volume of pedestrian or vehicular traffic.

Adopted on motion by Supervisor Pritchard, seconded by Supervisor Chesbro and the following vote:

- AYES: Supervisors— Renner, Pritchard, Chesbro, Walsh, Sparks
- NOES: Supervisors— None
- ABSENT: Supervisors— None
- ABSTAIN: Supervisors— None

STATE OF CALIFORNIA }  
County of Humboldt } ss

I, ROBERT E. HANLEY, Clerk of the Board of Supervisors, County of Humboldt, State of California, do hereby certify the foregoing to be a full, true and correct copy of the original made in the above entitled matter by said Board of Supervisors at a meeting held in Eureka, California as the same now appears of record in my office.

IN WITNESS WHEREOF, I have hereunto set my hand and affixed the Seal of said Board of Supervisors

ROBERT E. HANLEY January 18, 1983

Clerk of the Board of Supervisors of the County of Humboldt, State of California

By Doris L. Smith  
Deputy

EXHIBIT A

All that real property situated in the Town of Garberville, County of Humboldt, State of California, as shown on the Official Map of Garberville, as recorded in Book 11 of Surveys, pages 10 and 11 in the Office of the Humboldt County Recorder described as follows:

BEGINNING at a point that lies S 87° 51' E, 100.00 feet from the Southwest Corner of Lot 15, Block 11, according to the Official Map of Garberville;

THENCE, N 2° 09' E, 628.00 feet to a point that lies 175.13 feet south of the south line of Maple Lane as shown on said official map;

THENCE, S 87° 51' E, 50 feet;

THENCE, N 2° 09' E, 215.13 feet to the North line of Maple Lane;

THENCE, N 87° 51' W, 17.02 feet to the Southeast corner of Lot 7, Block 7 as shown on the Official Map of Garberville;

THENCE, N 3° 11' E, along the east line of Lot 7 to the Northeast corner of Lot 7;

THENCE, Northerly to the Southeast corner of Lot 5, Block 7 of the Official Map of Garberville;

THENCE, N 3° 11' E, along the east line of said Lot 5 and the northerly prolongation thereof to its intersection with the north line of Conger Street as shown on the said map of Garberville;

THENCE, N 88° 31' W, along the north line of Conger Street, and the westerly prolongation thereof to a point that lies 104 feet west of the most easterly line of Lot 1 Block 1 of the Official Map of Garberville;

THENCE, S 2° 09' W, to a point that lies N 87° 51' W, 14.00 feet from the Southeast corner of Lot 6 of said Block 1;

THENCE, N 87° 51' W, 35.02 feet to the easterly line of that parcel of land conveyed to Veldon W. Nixon and wife by deed recorded in Book 553 of Official Records, page 501, H.C.R.

THENCE, N 29° 49' W, 30 feet;

THENCE, S 60° 11' 40" W, 50 feet;

THENCE, S 29° 49' E, 34 feet to a point that lies N 29° 49' E 106 feet from the north line of Briceland Road as shown on said Official Map of Garberville;

THENCE, S 60° 11' 40" W, parallel to the north line of said Briceland Road, 206 feet to the east line of State Highway 101 as shown on California State Department of Public Works survey between 1.6 miles south of Garberville and 0.4 miles north of Dean Creek (State Highway 01-HUM-101)

THENCE, Southerly along the east line of said State Highway survey to the east line of lot 2, Block 12 of the Official Map of Garberville;

THENCE, S 29° 49' E, to the north line of Briceland Road as shown on said Official Map of Garberville;

THENCE, S 60° 11' 40" W, to a point that lies N 29° 48' 20" West of the Northwest corner of Lot 6 Block 13 of the Official Map of Garberville;

THENCE, S 29° 48' 20" E, 60 feet to said northwest corner of Lot 6 Block 13;

THENCE, S 35° 48' E, 129.62 feet;

THENCE, S 87° 51' E, 98.20 feet to the Northwest corner of Lot 11 Block 13 of the Official Map of Garberville;

THENCE, S 2° 09' W, along the west line of lot 11 and lot 12 of said Block 13 to the north line of that parcel of land conveyed to Marvin L. Gilbertson and wife by deed recorded January 15, 1981, in Volume 1633 of Official Records, page 111, Humboldt County Records;

THENCE, Southwesterly along the north line of said Gilbertson parcel to the east line of that parcel conveyed to Edward L. Williams and wife by deed recorded on July 23, 1969 in Volume 1010 of Official Records, page 443 of Humboldt County Records;

THENCE, Southeasterly and southwesterly along the east and south boundaries of said Williams parcel to the east line of State Highway 101, as shown on California State Department of Public Works survey between 1.6 miles south of Garberville and 0.4 miles north of Dean Creek (State Highway 01-Hum-101);

THENCE, Southerly along the east line of said California State Highway survey to the northwest corner of that real property as granted to Lester R. Olsen and wife as recorded in Book 900 of Official Records, page 644 H.C.R., (said point lies S 26° 41' 05" W, 356.72 from Monument No. 9 of said Official Map of Garberville);

THENCE, N 84° 37' 53" E, along the north line of the above mentioned real property 100.17 feet to the west line of Redwood Drive (Old State Highway 101), County Road Number 6B105;

THENCE, S 2° 09' E, along said west line of Redwood Drive to a point that lies N 87° 51' W from the southwest corner of Lot 6, Block 15 of the Official Map of Garberville;

THENCE, S 87° 51' E, 100.00 feet to the southwest corner of Lot 6 Block 15;

THENCE, along the boundaries of said Lot 6, N 88° 06' E 98 feet;

THENCE, N 59° E, 94.6 feet;

THENCE, N 36° 03' W, to the south corner of Parcel 2 as shown on Parcel Map No. 349, as recorded in Book 3 of Parcel Maps, page 109, H.C.R.;

THENCE, Northerly along the east boundary of said parcel 2, N 20° 54' E, 185.50 feet;

THENCE, N 24° 22' W, 51.24 feet;

THENCE, N 5° 29' 30" W, 56.62 feet;

THENCE, S 72° 39' E, 16.02 feet;

THENCE, N 17° 21' E, 82.61 feet;

THENCE, S 59° 53' E, 36.76 feet;

THENCE, N 30° 07' E, 95.00 to the south line of Parcel B as shown on said Parcel Map No. 349;

THENCE, Westerly along the south line of Parcel B and Parcel A to a point that lies S 2° 09' W from the point of beginning;

THENCE, N 2° 09' W, 45 feet to the POINT OF BEGINNING.

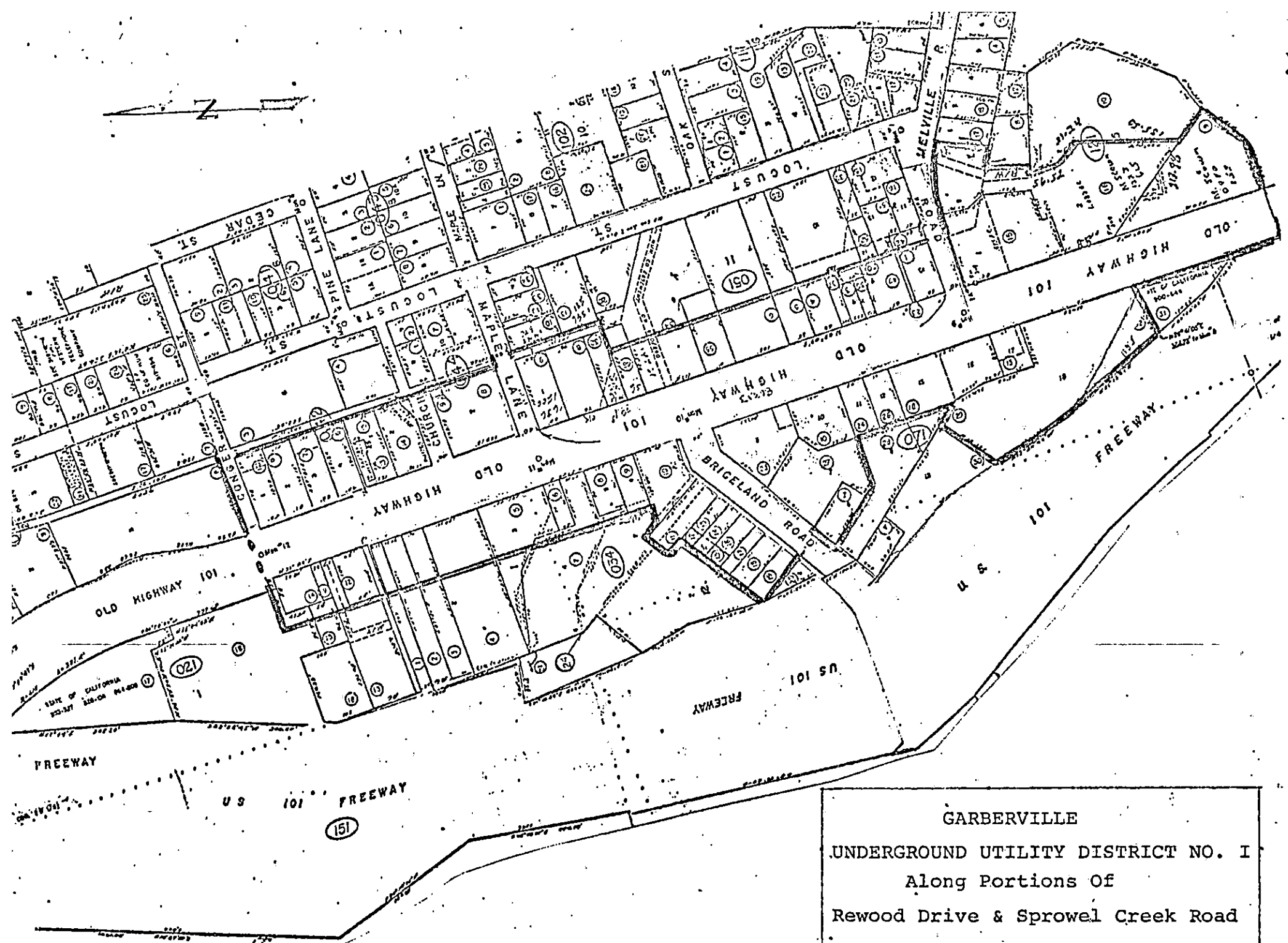

GARBERVILLE  
 UNDERGROUND UTILITY DISTRICT NO. I  
 Along Portions Of  
 Rewood Drive & Sprowel Creek Road