



HUMBOLDT COUNTY FOOD FACILITY PLAN CHECK GUIDE

Division of Environmental Health
100 H Street, Suite 100
Eureka, California 95501
707-445-6215
Fax: 707-441-5699

February 2009

PREFACE

The Humboldt County Food Facility Plan Check Guide is based on the California Conference of Directors of Environmental Health California Plan Check Guide for Retail Food Facilities. The California Plan Check Guide for Retail Food Facilities is an outline of requirements for design plan preparation before the submission to the local enforcement agency. The requirements are provided to assist in meeting applicable health and safety requirements. The Plan Check Guide is intended to give basic information and not to supersede any state law, local ordinance, or code.

Code numbers in this document refer to the section of the California Health and Safety Code, also known as the California Retail Food Code (CalCode) that is the source of the requirements. Recommendations, which follow the requirement contained within the Guide, are not requirements in state law or regulation and are included for clarification and to give examples for meeting the intent of CalCode. The recommendations may not be applicable in all circumstances. Refer to CalCode (California Health and Safety Code, Division 104, Part 7, Section 113700 et. seq.) for specific code requirements.

Complete, easily-readable plans drawn to scale and specifications must be submitted to the local enforcement agency for review and approval before starting any new construction or remodeling of any facility for use as a retail food facility. Plans and specifications are required by the Division of Environmental Health to assure compliance with CalCode. CalCode applies throughout California. Other state regulations and policies may apply or may be used by the local health agency.

This guide only encompasses food safety aspects and should not be construed to encompass other agencies involved, such as the local planning and zoning department, the local building authority, or local fire department. Owners and agents are advised to contact the appropriate local agencies involved to obtain any permits and/or to clarify other local codes.

TABLE OF CONTENTS

Construction Plan Approval Procedures for Food Facilities	1
I. Minimum Requirements for Food Facility Plans	2
II. Field Construction Inspection Procedure	2
Preliminary construction inspection	
Final construction inspection	
III. Structural Requirements	2
Floors	2
Walls and Ceilings	3
Conduits	4
Pass-Through Windows	4
Food Protection Equipment	4
Dry Food and Beverage Storage	4
Other Required Storage Facilities	5
Recyclables and Refuse Disposal Facilities	5
Toilet Facilities	5
Clothing Change Rooms and Areas	6
Exterior Doors and Windows	7
Delivery and Cargo Doors	7
Insect Control Devices	7
Lighting	7
Water	8
Backflow Protection	8
Indirect Waste Receptors	8
Sewage Disposal, Grease Traps and Interceptors	9
IV. Ventilation	9
Exhaust Hoods and Ducts	9
V. Equipment Requirements	10
Refrigeration	11
Sinks	11
Kitchen Utensil Sinks	11
Eating and Drinking Utensil Sinks	11
Food Preparation Sink	12
Handwashing Sinks	12
Janitorial Sink	12
Dishwashing and Glass Washing Machines	12
Dipper Well	13
VI. Appendices	14
Sample Floor Plan	
Sample Equipment List	
Requirements for Ventilation Hood Design Plans	
Ventilation Hood Worksheet	
Sample Room Finish Schedule	
Hot Water Demands Worksheet	
Flooring Guidelines	

Construction Plan Approval Procedures for Food Facilities

Pursuant to the California Health and Safety Code, Chapter 13, California Retail Food Code (CalCode), §114380, a plan approval must be obtained from the local health agency before constructing or remodeling any building for use as a food facility.

Remodel of a food facility means construction, building, enlarging, altering, converting, or repairing that requires a permit from the local building authority. CalCode, Chapter 1, §113715, provides for the following: Any construction, alteration, remodeling, or operation of a food facility shall be approved by the enforcement agency and shall be in accordance with all applicable local, state, and federal statutes, regulations, and ordinances including, but not limited to, fire, building, and zoning codes.

The following procedures are required to process and approve food facility plans as well as to obtain final approval to open for business:

1. The plans must include sufficient information to demonstrate compliance with the “Minimum Requirements for Food Facility Plans.” (see page 2)
2. Plans may be prepared by an architect, draftsman, designer, contractor or owner. All plans must be drawn to scale in a concise, detailed, and professional manner. Incomplete or inadequate plans will be rejected.
3. One complete set of detailed plans and specifications must be submitted, a Food Facility Plan Check Application form completed, and required plan check fees paid.
4. Upon approval, a copy of the plan approval letter will be forwarded to the building department, and the submitted plan set will be kept on file by the health agency until construction has been completed. An approved set of plans must be maintained at the construction site until the final inspection has been made.
5. Before commencing construction, approvals must be obtained from the local health agency, local building authority, and other appropriate agencies. Building permits for food facilities are not to be issued until plan approval has been obtained from the local health agency. The building department will not review forwarded plans. Separate submittals must be made to both Environmental Health and your local building official.
6. If any changes on the approved plans are desired, revised plans must be submitted for review and approval prior to construction.
7. A construction check inspection is required before floor coverings and/or kitchen equipment is installed. In some cases, it may be advisable to call for an additional inspection upon completion of plumbing “rough-in,” prior to pouring concrete.
8. All construction and equipment installation shall be subject to field inspection. The food facility must not open for business until final approval is obtained from the local enforcement agency and a valid food facility permit is issued. A separate permit application and annual permit fee, as well as a pre-opening inspection, is required before the food facility may operate. Call Environmental Health at 707-445-6215 to schedule inspections.

I. Minimum Requirements for Food Facility Plans

Plans must be drawn to scale with a recommended scale of “1/4 inch = 1 foot.” The plans must include the following:

- A. Name and address of the food facility. Provide the name, mailing address, and telephone number of the owner, the contractor, and/or other contact person.
- B. Floor plan of entire facility.
- C. Complete equipment checklist, including the methods of installation (see Appendix).
- D. Equipment manufacturer specification “cut sheets” and elevations.
- E. Floor plan showing equipment layout including: (see Appendix)
 - Plumbing layout.
 - Electrical layout.
 - Exhaust hood ventilation and make-up air systems. Complete the attached worksheet for each ventilation hood (see Hood Plan Check Guide).
 - Location of waste storage receptacles and recycling area.
- F. Room finish schedule for floors, base, walls, and ceiling indicating the type of material, color, and surface finish for each room or area. Provide specific brand names. Samples or specifications of proposed finish materials are required (see Appendix).
- G. Hot Water Demands worksheet
- H. Proposed sample menu.

II. Field Construction Inspection Procedure

- A. Preliminary construction inspection:

Contact Environmental Health to request a preliminary construction inspection prior to installation of floor covering and food service equipment.

- B. Final construction inspection:

Upon completion of construction, including finishing work, contact Environmental Health to arrange for a final construction inspection. Approved materials and good workmanship are significant factors in the evaluation and final field approval of food facility construction and equipment installation. A final inspection must be requested no less than five (5) working days prior to the proposed opening of the establishment. Final construction must be approved by Environmental Health and food facility permit issued prior to opening for business or use of remodeled areas.

III. Structural Requirements

The plans must show and specify in detail the following:

Floors:

- A. In all areas in which food is prepared, prepackaged, or stored, where any utensil is washed, where refuse or garbage is stored, where janitorial facilities are located, and in all toilet and handwashing areas, the floor surfaces must be smooth and of durable construction and nonabsorbent material that is easily cleanable. See DEH Guidelines for Flooring in a Food Facility for further detail. (CalCode 114268)

- B. Floor surfaces must be coved at the juncture of the floor and wall with a 3/8 inch minimum radius coving and shall extend up the wall at least 4 inches, except in areas where food is stored only in unopened bottles, cans, cartons, sacks, or other original shipping containers. Vinyl rubber top-set base coving is not acceptable. (CalCode 114268)
- C. Public or private schools constructed or remodeled after the effective date of this part must comply with subdivision B. Public and private schools constructed before the effective date of this part need not comply with subdivision B, provided that the existing floor surfaces are maintained in good repair and in a sanitary condition. (CalCode 114268)
- D. Exceptions include sales areas, or with respect to areas relating to guestroom accommodations and the private accommodations of owners and operators in restricted food service facilities, and in employee change and storage areas. (CalCode 114268)
- E. Upon new construction or extensive remodeling, floor drains must be installed in floors that are water-flushed for cleaning and in areas where pressure spray methods for cleaning equipment are used. Floor surfaces in areas pursuant to this subdivision shall be sloped 1:50 to the floor drains. (CalCode 114269)
- F. Upon new construction or extensive remodeling, floor sinks or equivalent devices must be installed to receive discharges of water or other liquid waste from equipment. (CalCode 114269)

Walls and Ceilings:

- A. Except as provided in subdivision B (below), the walls and ceilings of all rooms shall be of a durable, smooth, nonabsorbent, and easily cleanable surface (e.g., gloss or semi-gloss enamel paint, epoxy paint, FRP (fiberglass reinforced panel) or NRP (nylon reinforced plastic), stainless steel, ceramic tile, or other approved materials and finishes). Exposed brick, concrete block, rough concrete, rough plaster, or textured gypsum board is not acceptable. A sample may be required for review. (CalCode 114271)
- B. This section shall not apply to any of the following areas:
 - 1. Walls and ceilings of bar areas in which alcoholic beverages are sold or served directly to the consumers, except wall areas adjacent to bar sinks and areas where food is prepared.
 - 2. Areas where food is stored only in unopened bottles, cans, cartons, sacks, or other original shipping containers.
 - 3. Dining and sales areas.
 - 4. Offices.
 - 5. Restrooms that are used exclusively by the consumers, except that the walls and ceilings in the restrooms shall be of a nonabsorbent and washable surface.
- C. Acoustical paneling may be utilized if it is installed not less than six feet above the floor. The paneling must meet the other requirements of this section. (CalCode 114271)
- D. Attachments to walls and ceilings, such as light fixtures, mechanical room ventilation system components, vent covers, wall mounted fans, decorative items, and other attachments, must be easily cleanable. (CalCode 114271)
- E. The wall behind sinks and dishtables must be covered with a durable waterproof material (e.g., FRP, ceramic tile, stainless steel, etc.) extending from the top of the coved base to at least twelve (12) inches above the backsplash. (CalCode 114271)
- F. Walls adjacent to floor-mounted mop sinks must be covered with a durable waterproof material (e.g., FRP, ceramic tile, stainless steel, etc.) extending from the top of the sink to at least forty-eight (48) inches above the floor. (CalCode 114271)

- G. Provide a durable, cleanable, smooth, non-corrodible, and nonflammable material (e.g., stainless steel, ceramic tile, etc.) behind the cook line and to any side walls adjacent or in close proximity. (CalCode 114271)
- H. When a dishtable is installed next to a wall, the integral metal backsplash must be sealed to the wall. Other equipment that is exposed to spillage or see page, must also be sealed to the wall. (CalCode 114169)

Conduits:

- A. All plumbing, electrical and gas lines must be concealed within the building structure to as great an extent as possible. When otherwise installed, they must be mounted or enclosed so as to facilitate cleaning (e.g., at least one-half inch from the wall and six (6) inches above the floor). (CalCode 114271)
- B. Where conduits or pipelines enter a wall, ceiling, or floor, the opening around the line must be tightly sealed and made smooth. (CalCode 114271)
- C. Conduits or pipelines must not be installed across any aisle, traffic area, or door opening. (CalCode 114271)
- D. Multiple runs or clusters of conduits or pipelines must be installed within the walls or encased in an approved sealed enclosure. (CalCode 114271)

Pass-through Windows:

Pass-through window service openings must be limited to 216 square inches each. The service openings shall not be closer together than 18 inches. Each opening must be provided with a solid or screened window, equipped with a self-closing device. Screening must be at least 16 mesh per square inch. Pass-through windows of up to 432 square inches are approved if equipped with an air curtain device. The counter surface of the service openings must be smooth and easily cleanable. (CalCode 114259.2)

Food Protection Equipment:

Food on display must be protected from contamination by the use of packaging, service counter, service line, sneeze guards (that intercept a direct line between the consumer's mouth and the food being displayed), containers with tight-fitting securely-attached lids, display cases, mechanical dispensers, and/or other effective means. (CalCode 114060, 114063, 114065)

Dry Food and Beverage Storage:

Adequate and suitable space must be provided and designated on plans for dry storage purposes. This area must be equipped with sufficient and approved shelving to accommodate anticipated needs. This section applies to aisle space and floor area where shelving, cabinets, or other storage facilities are located. This section does not apply to floor area where desks, equipment, ladders, or other items may be placed. (CalCode 114047)

Unfinished wood shelving is not acceptable. Painted wood is not recommended. The following recommended methods of determining adequate storage space may be used:

- A floor area equivalent to 25% of all kitchen space, or
- One square foot of floor space per customer seat, or
- Sufficient approved shelving dispersed throughout kitchen areas.

Sufficient approved shelving for a small food service establishment means ninety-six (96) linear feet of eighteen (18)-inch-deep shelving. More shelving may be required for larger establishments. (CalCode 114047)

Except as specified below, food must be protected from contamination by storing it in a clean, dry location, where it is not exposed to splash, dust, vermin, or other forms of contamination or adulteration, and at least six inches above the floor. (CalCode 114047)

Pressurized beverage containers, cased food in waterproof containers such as bottles or cans, and milk containers in plastic crates may be stored on a floor that is clean and not exposed to moisture. (CalCode 114047)

Other Required Storage Facilities:

Adequate and suitable space shall be provided for the storage of clean linens. (CalCode 114185.4)

A room, area, or cabinet separated from any food preparation area, food storage area, warewashing area, or ware storage area, must be provided for the storage of cleaning equipment and supplies (e.g., mops, buckets, brooms, cleaning compounds, waxes, insecticides, rodenticides, pesticides, detergents, bleaches, cleaning compounds, or any other injurious or poisonous materials). (CalCode 114281)

Recyclables and Refuse Disposal Facilities:

Each food facility shall be provided with any facilities and equipment necessary to store or dispose of all waste material, including used oil and fryer grease. A receptacle shall be provided in each area of the food facility or premises where refuse is generated or commonly discarded, or where recyclables or returnables are placed. (CalCode 114244)

Garbage and waste oil or grease must be disposed into adequate, watertight, non-absorbent, rodent-proof containers with close-fitting lids. There shall be an area provided for the storage of these containers and facilities for their washing. If provided, an outdoor storage area or enclosure used for refuse, recyclables, and returnables must be constructed of nonabsorbent material, such as concrete or asphalt, and must be easily cleanable, durable, and sloped to drain. (CalCode 114245)

All recyclables must be stored so as to prevent attraction and harborage of vermin. (CalCode 114259)

Suitable cleaning implements and supplies such as high pressure pumps, hot water, steam, and detergent must be provided as necessary for effective cleaning of receptacles and waste handling units for refuse, recyclables, and returnables. (CalCode 114245.7)

Other structural requirements for refuse disposal rooms and areas:

1. Floors shall be smooth, durable, oil-resistant, non-absorbent, coved, easily cleanable, and sloped to a floor drain discharging to the sanitary sewer. (CalCode 114268)
2. Walls and ceilings shall be durable, easily cleanable, impervious to grease and moisture, and capable of withstanding the expected impacts. (CalCode 114271)
3. The room or enclosure shall be well ventilated. (CalCode 114149)

Toilet Facilities:

Clean toilet rooms in good repair shall be provided and conveniently located and accessible for use by employees during all hours of operation. The number of toilet facilities required shall be in accordance with applicable local building and plumbing ordinances. Toilet tissue must be provided in a permanently installed dispenser at each toilet. (CalCode 114250)

Food facilities located within amusement parks, stadiums, arenas, food courts, fairgrounds, and similar premises shall not be required to provide toilet facilities for employee use within each food facility if approved toilet facilities are located within 200 feet in travel distance of each food facility and are readily available for use by employees. Food facilities subject to this section must be provided with approved handwashing facilities for employee use.

Notwithstanding the section above, food facilities approved prior to the effective date of this part with toilet facilities within 300 feet are not required to meet the 200-foot requirement. (CalCode 114250.1)

A permanent food facility must provide clean toilet facilities in good repair for consumers, guests, or invitees when:

- There is onsite consumption of foods
- OR
- When the food facility was constructed after July 1, 1984, *and* has more than 20,000 square feet of floor space.

A building subject to the above conditions that has a food facility with more than 20,000 square feet of floor space must provide at least one separate toilet facility for men and one separate toilet facility for women.

Any building that was constructed before January 1, 2004, that has a food facility that provides space for the consumption of food on the premises must either provide clean toilet facilities in good repair for consumers, guests, or invitees on property used in connection with, or in, the food facility or prominently post a sign within the food facility in a public area stating that toilet facilities are not provided. (CalCode 114276)

Toilet facilities that are provided for use by consumers, guests, or invitees shall be in a location where consumers, guests, and invitees do not pass through food preparation, food storage, or utensil washing areas to reach the toilet facilities.

Handwashing facilities must be provided within or adjacent to toilet rooms and must be equipped with an adequate supply of hot and cold running water under pressure from a premixing faucet. Handwashing cleanser and single-use sanitary towels in permanently installed dispensers or hot air blowers must be provided at handwashing facilities. (CalCode 113953, 113953.3)

Toilet rooms must be separated by well-fitted, self-closing doors that prevent the passage of flies, dust, or odors. (CalCode 114276)

Toilet rooms shall be vented to the outside air by means of an openable, screened window, an air shaft, or a light-switch-activated exhaust fan, consistent with the requirements of local building codes. (CalCode 114149)

Clothing Change Rooms and Areas:

Lockers or other suitable facilities must be provided and used for the orderly storage of employee clothing and other possessions. Dressing rooms or dressing areas must be provided and used by employees if the employees regularly change their clothes in the facility. Restricted food service facilities and nonpermanent food facilities must not be required to comply with the above requirements, but no person shall store clothing or personal effects in any area used for the storage and preparation of food. (CalCode 114256.1)

Areas designated for employees to eat and drink must be located so that food, equipment, linens, and single-use articles are protected from contamination. Lockers or other suitable facilities must be located in a designated room or area where contamination of food, equipment, utensils, linens, and single-use articles cannot occur. (CalCode 114256)

Exterior Doors and Windows:

A food facility must at all times be constructed, equipped, maintained, and operated as to prevent the entrance and harborage of animals, birds, and vermin, including, but not limited to, rodents and insects. All exterior doors must be well-fitted and self-closing to effectively prevent the entrance of animals, birds, and vermin. All exterior windows which open to food preparation areas, food storage areas and utensil washing areas must be screened with no less than sixteen (16) mesh per square inch. (CalCode 114259)

Delivery and Cargo Doors:

All delivery doors leading to the outside must open outward and be self-closing. Overhead air curtains must be provided when delivery doors remain open for an extended period of time and when necessary to exclude insects, dust, dirt, and fumes. Large cargo-type doors must not open directly into a food preparation area. Cargo-type doors that open into any food warehouse of a food facility may only be open during deliveries. An overhead air curtain is not a substitute device to permit a door to remain open constantly. The air curtain when installed inside the building shall produce a downward and outward air flow not less than three (3) inches thick at the nozzle with an air velocity of not less than 1600 FPM (feet per minute) across the entire opening at a point three (3) feet above the floor. (CalCode 114259, 114259.1), (State of California, Food and Drug Circular 80-7)

Insect Control Devices:

Insect control devices that are used to electrocute or stun flying insects must be designed to retain the insect within the device. Insect control devices must be installed so that the devices are not located over a food or utensil handling area and dead insects and insect fragments are prevented from being impelled onto or from falling on nonprepackaged food, clean equipment, utensils, linens, and unwrapped single-use articles. (CalCode 114259.3)

Lighting:

In every room and area in which any food is prepared, manufactured, processed, or prepackaged, or in which equipment or utensils are cleaned, sufficient natural or artificial lighting must be provided to produce the following light intensity, while the area is in use:

- A. At least 10-foot candles at a distance of 30 inches above the floor, in walk-in refrigeration units and dry food storage areas.

- B. At least 20-foot candles for the following:
 - 1. At a surface where food is provided for consumer self-service or where fresh produce or prepackaged foods are sold or offered for consumption.
 - 2. Inside equipment such as reach-in and under-counter refrigerators.
 - 3. At a distance of 30 inches above the floor in areas used for handwashing, warewashing, equipment storage, utensil storage, and in toilet rooms.
- C. At least 50-foot candles at a surface where a food employee is working with food, or working with utensils or equipment, such as knives, slicers, grinders, or saws where employee safety is a factor and in other areas and rooms during periods of cleaning. (CalCode 114252)

Light bulbs must be shielded, coated, or otherwise shatter-resistant in areas where there is nonprepackaged ready-to-eat food, clean equipment, utensils, linens, or unwrapped single-use articles. Shielded, coated, or otherwise shatter-resistant bulbs need not be used in areas used only for storing prepackaged food in unopened packages, if the integrity of the packages cannot be affected by broken glass falling onto them and the packages are capable of being cleaned of debris from broken bulbs before the packages are opened. Infrared and other heat lamps must be protected against breakage by a shield surrounding and extending beyond the bulb so that only the face of the bulb is exposed, or by using approved coated shatter-resistant bulbs. (CalCode 114252.1)

Water:

An adequate, protected, pressurized, potable supply of hot water and cold water must be provided. Hot water must be supplied at a minimum temperature of at least 120°F measured from the faucet, unless otherwise specified in this part. The water supply must be from a water system approved by the health officer or the local enforcement agency. (CalCode 114192)

The enforcement agency may monitor and enforce the potable drinking water standards provided in the California Safe Drinking Water Act (Chapter 4 commencing with Section 116275) for purposes of enforcing this part and compliance with any requirements with regard to potable water. If your proposed facility is located in an unincorporated area, your water supply may require additional review, including on-going biological sampling, and may be subject to the State of California drinking water regulations, titled "Transient Non-Community Water System." See the Consumer Protection unit for an application. (CalCode 113869, 114189)

In sizing the water heater, the peak hourly demands for all sinks, dishwashing machines, etc., are added together to determine the minimum required recovery rate. (*Refer to "CCDEH Water Heater Sizing Guidelines"*).

Backflow Protection:

The potable water supply must be protected with a backflow or back siphonage protection device when required by applicable plumbing codes. Exposed piping of a non-potable water system must be identified so that it is readily distinguishable from piping that carries potable water. (CalCode 114192)

Indirect Waste Receptors:

All steam tables, ice machines and bins, food preparation sinks, warewashing sinks, display cases, walk-in refrigeration units, and other similar equipment that discharge liquid waste must be drained by means of indirect waste pipes, and all wastes drained by them must discharge through an air gap into a floor sink or other approved type of receptor.

Drainage from reach-in refrigeration units must be conducted in a sanitary manner to a floor sink or other approved device by an indirect connection or to a properly installed and functioning evaporator.

Indirect waste receptors must be located to be readily accessible for inspection and cleaning. Warewashing machines may be connected directly to the sewer immediately downstream from a floor drain, or they may be drained through an approved indirect connection.

Warewashing sinks in use on January 1, 1996, that are directly plumbed, may be continued in use. This section does not require warewashing sinks to be indirectly plumbed when the local building official determines that the sink should be directly plumbed. (CalCode 114193)

An air gap between the water supply inlet and the flood level rim of the plumbing fixture, equipment, or nonfood equipment must be at least twice the diameter of the water supply inlet and may not be less than one inch. (CalCode 114193.1)

In general, floor sinks must be installed flush with the final grade of the finished floor to prevent tripping hazards and prevent harborage of dirt and debris. However, some situations may require floor sinks above grade. Check with the local Building Department for requirements.

Sewage Disposal, Grease Traps and Interceptors:

Liquid waste must be disposed of through the approved plumbing system and must discharge into the public sewerage or into an approved private sewage disposal system. If your proposed facility is located in an unincorporated area, your water and sewage disposal systems may require additional review. If a public sewer system is available in your area, you will be required to connect. If no public sewer system is available, you must have an approved on-site sewage disposal system. See the Environmental Health Land Use unit for more information. (CalCode 114197)

NOTE: Check with local health, building, sanitary, public works agencies, or community services district for information or regulations regarding special sewerage, grease trap, and grease-interceptor requirements. In general, to facilitate cleaning and servicing, grease traps should not be installed underneath equipment.

If provided, a grease trap or grease interceptor shall not be located in a food or utensil handling area unless specifically approved by Environmental Health. Grease traps and grease interceptors must be easily accessible for servicing. Food facilities approved with a grease trap or grease interceptor that are in operation before the effective date of this part are not required to comply with this section. (CalCode 114201)

IV. Ventilation

All areas of a food facility must have sufficient ventilation to facilitate proper food storage and to provide a reasonable condition of comfort for each employee, consistent with the job performed by the employee. (CalCode 114149)

Exhaust Hoods and Ducts:

Mechanical exhaust ventilation equipment must be provided over all cooking equipment (all commercial-type deep fat fryers, broilers, fry grills, steam-jacketed kettles, ranges, ovens, barbecues, rotisseries, dishwashing machines, and other similar equipment) as required to effectively remove cooking odors, smoke, steam, grease, heat, and vapors. All mechanical exhaust ventilation equipment must be installed and maintained in accordance with the California Mechanical Code, except that for units subject to Part 2 (commencing with Section 18000) of Division 13, an alternative code adopted pursuant to Section 18028 shall govern the construction standards. Makeup air must be provided at the rate of that exhausted. (CalCode 114149.1)

Ventilation plans for each system must include front and side elevations of the exhaust hood and duct details to the roof fans (both exhaust and make-up air). [See Appendix C] Provide manufacturer specification sheets for exhaust fan, make-up air fan, and hood filters along with the static pressure calculations. Specify the number and location of make-up air diffuser. Complete the vent hood work sheet provided in Hood Plan Check Guide. A balance report completed by a third party may be required prior to final clearance.

Refer to Uniform Mechanical Code Chapter on Commercial Kitchen Ventilation Systems. Refer to CCDEH Recommendations for Mechanical Exhaust Ventilation and Hood Systems for Commercial Food and Utensil Heat Processing Equipment Guidelines.

V. Equipment Requirements

New and replacement food-related and utensil-related equipment must be certified or classified for sanitation by an American National Standards Institute (ANSI) accredited certification program. (CalCode 114130)

Materials used in the construction of utensils and food-contact surfaces of equipment (display cases, windows, counters, shelves, tables, refrigeration units, sinks, dishwashing machines, and other equipment or utensils used in the preparation, sale, service, and display of food) must not allow the migration of deleterious substances or impart colors, odors, or tastes to food. Under normal-use conditions equipment materials must be safe, durable, corrosion-resistant, nonabsorbent, sufficient in weight and thickness to withstand repeated warewashing, finished to have a smooth, easily cleanable surface, and resistant to pitting, chipping, crazing, scratching, scoring, distortion, and decomposition. (CalCode 114130.1)

All floor-mounted equipment shall be placed on casters to allow cleaning of the equipment and areas underneath and around the equipment. Equipment that is fixed because it is not easily movable must be installed so that it is:

- Spaced to allow access for cleaning along the sides, behind, and above the equipment.
- Spaced from adjoining equipment, walls, and ceilings a distance of not more than one millimeter or one thirty-second inch.
- Sealed to adjoining equipment or walls, if the equipment is exposed to spillage or seepage.

Floor-mounted equipment that is not easily movable must be sealed to the floor or elevated on legs that provide at least a six-inch clearance between the floor and the equipment.

This section shall not apply to display shelving units, display refrigeration units, and display freezer units located in the consumer shopping areas of a food facility if the floor under the units is maintained clean.

Table-mounted equipment that is not easily movable must be installed to allow cleaning of the equipment and areas underneath and around the equipment by being sealed to the table or elevated on legs that provide at least a four-inch clearance between the table and the equipment. (CalCode 114169)

Refrigeration:

All reach-in and walk-in refrigeration and freezer units shall be adequate in capacity and usage to meet the needs of the proposed operation and must be certified or classified for sanitation by an American National Standards Institute (ANSI) accredited certification program. In the absence of an applicable ANSI certified sanitation standard, food-related and utensil-related equipment must be evaluated for approval by the enforcement agency. Domestic model refrigerators and freezers will not be accepted. (CalCode 114130)

All reach-in and walk-in refrigeration and freezer units shall have shelving that is non-absorbent, non-corrodible, easily cleanable, that is at least six (6) inches above the floor, and shall meet or be equivalent to applicable NSF standards. Wood is not acceptable. (CalCode 114047, 114130.1)

A thermometer must be provided for each refrigeration unit. (CalCode 114157)

Condensate and other liquid waste must drain in a sanitary manner to a floor sink or other approved receptor that is properly connected to an approved plumbing system and must discharge into the public sewerage or into an approved private sewage disposal system. Condensate from reach-in refrigerators and freezers may be drained to a properly installed and functioning evaporator. (CalCode 114197, 114268)

All reach-in and walk-in refrigeration and freezer units shall open into an approved area of the food facility. (CalCode 114266)

Walk-in refrigeration and storage freezer units shall also be designed to be closed and sealed to the floor or be constructed integral with the floor, and must be flashed or sealed to walls and/or ceiling as needed to prevent rodent and vermin harborage or inaccessible areas. Coved bases shall be provided at the intersection of interior floors and walls. (CalCode 114268, 114259)

Sinks:

When a sink is installed next to a wall, the integral metal backsplash shall be sealed to the wall. (CalCode 114271)

Hot and cold water under pressure must be provided through a mixing valve to each compartment of the following sinks:

A. Kitchen Utensil Sinks:

Manual warewashing sinks must have at least three compartments with two integral metal drainboards for manually washing, rinsing, and sanitizing equipment and utensils. Sink compartments must be large enough to accommodate immersion of the largest equipment and utensils. A compartment size of approximately 18 x 18 x 12 inches deep will generally be adequate for most utensils. A three-compartment sink may be required within each separate section of a large food establishment which handles unpackaged foods (i.e., deli, meat, bakery, sushi bars, oyster bars, etc.). (CalCode 114099)

B. Eating and Drinking "Multi-Service" Utensil Sinks:

Dishwashing machines are recommended where a large volume of eating and drinking utensils are washed. (CalCode 114099)

C. Food Preparation Sink:

A food preparation sink shall be provided in permanent food facilities for the washing, rinsing, soaking, thawing, or similar preparation of foods, that drains by means of an indirect connection. The food preparation sink shall have a minimum dimension of 18 inches by 18 inches in length and width, and 12 inches in depth, with an integral drainboard or adjacent table at least 18 inches by 18 inches in length and width. (CalCode 114163)

D. Handwashing Sinks:

Handwashing facilities must be sufficient in number and conveniently located so as to be accessible at all times for use by food employees. (CalCode 113953)

Handwashing sinks must be provided in each food preparation area (i.e., deli, meat department, bakery, sushi bar, etc.) and in warewashing areas that are not located within or immediately adjacent to food preparation areas. (CalCode 113953)

Each handwashing facility must be provided with dispensers of handwashing cleanser and sanitary single-use towels. A heated-air hand drying device may be used instead of single-use towels. Handwashing facilities must be equipped to provide warm water (minimum 100°) under pressure for a minimum of 15 seconds through a mixing valve or combination faucet. (CalCode 113953)

Handwashing facilities must be provided within or adjacent to toilet rooms. The number of handwashing facilities required must be in accordance with local building and plumbing codes. (CalCode 113953)

E. Janitorial Sink:

At least one curbed cleaning facility or janitorial sink equipped with a drain must be provided and conveniently located for the cleaning of mops or similar wet floor cleaning tools and for the disposal of mop water and similar liquid waste. (CalCode 114279)

An adequate, protected, pressurized, potable supply of hot water and cold water must be provided. Hot water must be supplied at a minimum temperature of at least 120°F measured from the faucet, unless otherwise specified in this part. (CalCode 114192)

The mixing valve faucet must be equipped with a backflow or back siphonage protection device when required by applicable plumbing codes. (CalCode 114192)

A room, area, or cabinet separated from any food preparation or storage area, or warewashing or storage area must be provided for the storage of cleaning equipment and supplies. (CalCode 114281)

F. Dishwashing and Glass Washing Machines:

During manual or mechanical warewashing, food debris on equipment and utensils must be scraped over a waste disposal unit, scupper, or garbage receptacle. If necessary for effective cleaning, utensils and equipment must be pre-flushed, pre-soaked, or scrubbed with abrasives. (CalCode 114099.1)

Warewashing machines may be connected directly to the sewer immediately downstream from a floor drain, or they may be drained through an approved indirect connection. (CalCode 114193)

If hot water is used for sanitization in manual warewashing operations, the sanitizing compartment of the sink shall be designed with an integral heating device that is capable of maintaining water at a temperature not less than 171°F and provided with a rack or basket to allow complete immersion of equipment and utensils into the hot water. (CalCode 114099.4)

A warewashing machine must be provided with an easily accessible and readable data plate affixed to the machine by the manufacturer that indicates the machine's design and operating specifications including the temperatures required for washing, rinsing, and sanitizing, the pressure required for the fresh water sanitizing rinse, unless the machine is designed to use only a pumped sanitizing rinse, and the conveyor speed for conveyor machines or cycle time for stationary rack machines. (CalCode 114101.1)

A warewashing machine must be equipped with a temperature measuring device that indicates the temperature of the water as the water enters the hot water sanitizing final rinse manifold or in the chemical sanitizing solution tank. (CalCode 114101.2)

All warewashing equipment must be provided with two integral metal drainboards of adequate size and construction. One drainboard shall be attached at the point of entry for soiled equipment and utensils and one shall be attached at the point of exit for cleaned and sanitized equipment and utensils. Where an under counter warewashing machine is used, there must be two metal drainboards, one for soiled equipment and utensils, and one for clean equipment and utensils, located adjacent to the machine. This requirement may be satisfied by using the drainboards that are part of the manual warewashing sinks if the facilities are located adjacent to the machine. Pot and pan washers must be equipped with drainboards or shall be equipped with approved alternative equipment that provides adequate and suitable space for soiled and clean equipment and utensils. Drainboards, utensil racks, or tables large enough to accommodate all soiled and cleaned items that may accumulate during hours of operation shall be provided for necessary utensil holding before cleaning and after sanitizing. Sinks and drainboards of warewashing equipment shall be sloped and drained to an approved liquid waste receptor. (CalCode 114103)

All food facilities in which food is prepared, or in which multi-service utensils and equipment are used, must provide manual methods to effectively clean and sanitize

utensils. A minimum of a three-compartment stainless steel sink with dual integral metal drainboards is required in addition to any dishwashing machine. (CalCode 114095)

When a dishtable is installed next to a wall, the integral metal backsplash must be sealed to the wall. (CalCode 114169)

G. Dipper Well:

A cold running water dipper well shall be provided, if scoops or other reusable serving utensils are stored in water. The dipper well must be drained by means of an indirect connection. (CalCode 114193)

VI. Appendices

The following appendices are for the sole purpose of illustration (except the exhaust ventilation worksheet and the hot water demands worksheet, which must be completed and submitted with the plans) to help the owner or agent understand the minimum requirements needed for the submission of plans for review and approval.

- Sample Floor Plan
- Sample Equipment List
- Requirements for Ventilation Hood Design Plans
- Ventilation Hood Worksheet
- Sample Room Finish Schedule
- Hot Water Demands Worksheet
- Flooring Guidelines

These samples are not to scale and are not to be copied as approved documents or submitted in any form or fashion.

EXAMPLE OF A FLOOR PLAN

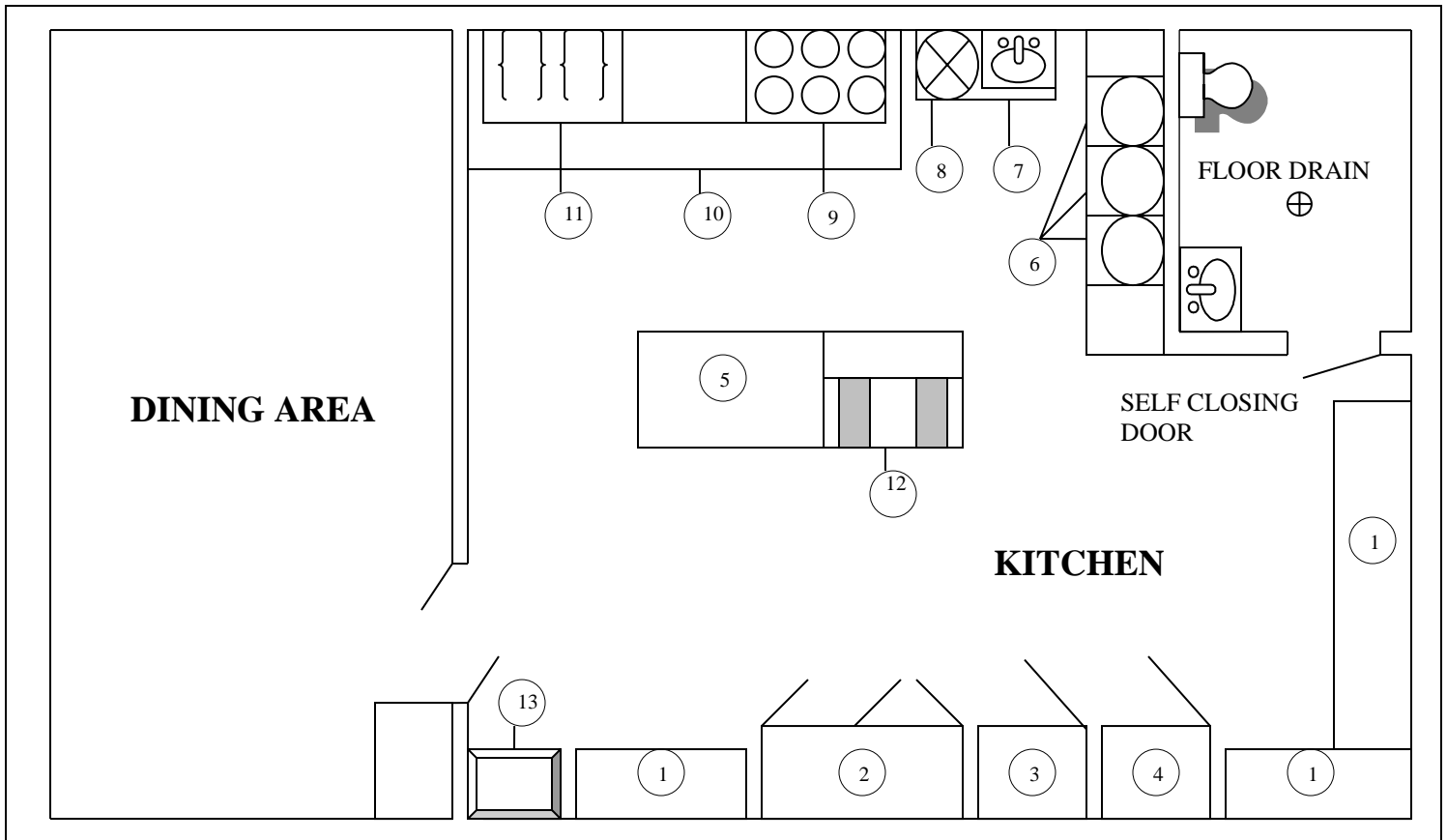

SUGGESTED FORMAT FOR EQUIPMENT LIST

Item No.	Description	Base	Manufacturer And Model #	Water		Waste	Remarks
				Hot	Cold		
1	Storage shelving	72" Posts	Shelf Co. Inc	N/A	N/A	N/A	
2	3-Door Reach-In Refrigerator	6" Legs	Ice-Kold #DA 943	N/A	N/A	Self-Contained	Condensate Evaporator Provided
3	1-Door Reach-In Refrigerator	6" Legs	Ice-Kold # AD439	N/A	N/A	See Above	See Above
4	Freezer	6" Legs	BRRR Inc. #123Z	N/A	N/A	See Above	See Above
5	Stainless Steel Work Table	Tube Legs	Krow Co. #CAW10	N/A	N/A	N/A	
6	3-Compartment Sink	20" Legs	Bum Equip. #987X	½"	½"	Floor Sink	Dual Drainboards
7	Hand Sink w/ Soap & Towel Dispenser	Mount on Wall	Wash Co. #XYZ	½"	½"	1 ¼"	
8	Floor Sink	Flush Mount on Floor	Acme #	N/A	N/A	N/A	
9	Range	6" Legs	WoodCo #2B	N/A	N/A	N/A	
10	Hood		Firefly #Buzz	N/A	N/A	N/A	Grease Filters
11	Fryer	Casters	KrispyCo #582L	N/A	N/A	N/A	
12	Salad Prep Unit	Casters	Lettom Inc #VBV2	N/A	N/A	Self Contained	
13	Janitorial Sink	Mount on Floor	Sink Co. # 555S	½"	½"	1 ¼"	

REQUIREMENTS FOR HOOD PLANS

- Provide 3 sets of plans using scale of ¼ inch per foot, including:

Hood Worksheet (see back of this page)

Plan view:

- Outline of hood over cooking equipment
- Clearances around equipment and to walls
- Exhaust and make-up air ducts
- Exhaust and make-up air fans on roof
- Make-up air diffusers on ceiling
- Make and model of equipment and fans

All dimensions of equipment and ducts

- Front & Side Elevations showing:

- Cooking equipment
- Hood overhang
- Duct elbows & fans

- Type & gauge of metal used in hood & ducts

- Specify if hood is Type I, Type II, UL Listed, non-canopy, compensating, etc.

Name, address, and phone number of facility hood designer

- Submit one set of manufacturers' specification sheets (cut-sheets) for:

-Cooking equipment

-Make-up air fan

-Exhaust fan

-UL listing card for hood system

- Plans shall conform to Uniform Mechanical Code

EXAMPLE OF ELEVATIONS

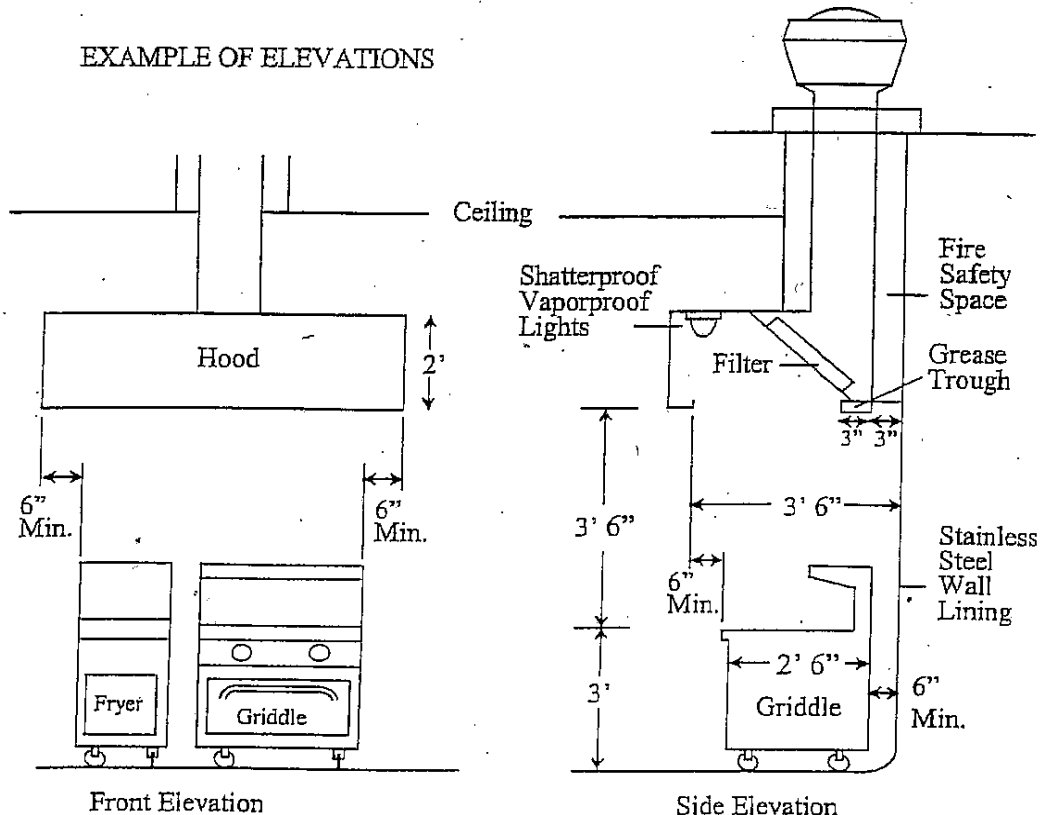

HOOD WORKSHEET

Facility Name: _____

Address: _____

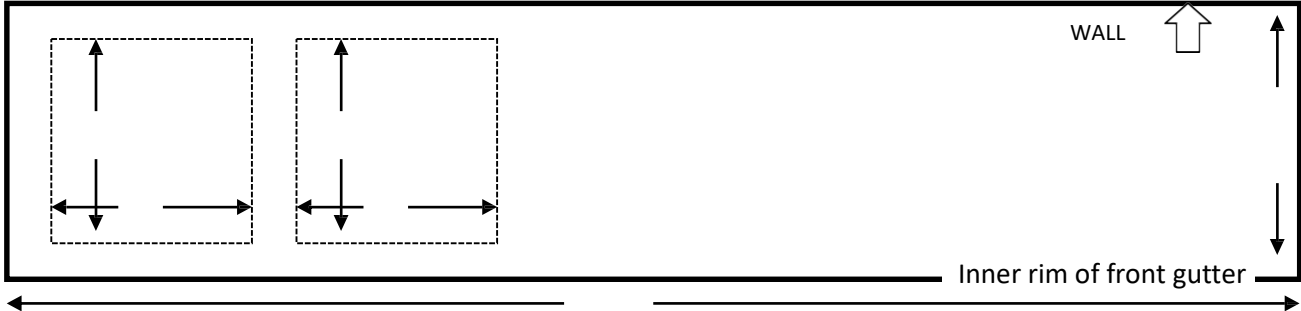

COOKING EQUIPMENT AND HOOD

- Fill in cooking equipment and hood dimensions in overhead view.
- Casters and quick disconnects **strongly** recommended! Specified? Yes No
- Hood long enough to allow ≥ 6 in. on sides of equipment? Yes No
- Hood wide enough to allow ≥ 6 in. front and back of equipment? Yes No
- Canopy lip ≥ 6.5 ft above floor and ≤ 4 ft above cooking surface? Yes No
- Canopy free of exposed horizontal electrical and Ansul lines? Yes No

AIR FLOW REQUIRED FOR CAPTURE (CFM)

- Make and model of hood? _____
- Hood Opening: Length _____ ft x Width _____ ft = _____ Sq ft _____
- Other Formula? Sq ft _____ x (Q factor from UMC) _____ = CFM _____
= CFM _____

VELOCITY REQUIRED AT FILTER BAFFLES FOR GREASE SEPARATION (FPM)

- Height _____ in x Width _____ in = _____ Filter size sq in
- Number of filters _____ x Useable area per filter _____ sq ft = _____ Total filter area sq ft
- _____ CFM \div _____ sq ft (total filter area) = _____ sq ft = FPM
- Baffle filter ideal = 300 FPM. Must be 250 – 350 FPM. Is it? Yes No
- Horizontal slot filter ideal = 1000 FPM. Must be 800 – 1200. Is it? Yes No N/A
- FPM can be more or less than above if this is a "LISTED" hood. Is it? Yes No
- Total filter widths (_____ inches) must be less than hood length. Is it? Yes No

DUCT VELOCITY FOR EXHAUST TO EXTERIOR (FPM)

- Duct dimensions: _____ in x _____ in \div 144 (sq in /sq ft) = _____ sq ft duct cross-section
- Hood longer than 12 ft. is provided with more than 1 exhaust outlet to main duct? Yes No N/A
- _____ CFM of hood flow \div _____ sq ft duct cross-section = _____ FPM
- Duct ideal = 1800 FPM. Must be 1500 - 2500 (for Type I hood). Is it? Yes No N/A

STATIC PRESSURE (SP) AND EXHAUST FAN (CFM)

- Number of Elbows = _____ Cleanout at each elbow? _____ Yes No N/A
- Static Pressure ≈ _____ in/ SP
- Exhaust Fan: Make _____ Model # _____ HP _____
- Fan is UL for grease (for Type I)? Yes No Easily pulls CFM at SP? Yes No

MAKE-UP AIR (CFM)

- _____ CFM of hood flow ÷ 2000 CFM = _____ number of diffusers
Next Higher whole number = _____ diffusers required
- Make-up air Static Pressure ≈ _____ in. of SP
- Make-up air fan: Make _____ Model # _____ HP _____
- Supplies 95-100% of exhaust CFM at SP? Yes No
- Make-up air on roof ≥ 10 ft. from exhaust? Yes No N/A
- Diffusers on ceiling ≥ 10 ft. from hood? Yes No
- Exhaust and make-up air electrically interlocked? Yes No

Prepared by: _____

Name

Company

Phone

Date

THIS IS A SAMPLE ONLY

(Specific brand names and colors for materials should be specified to insure acceptability)

Sample Room Finish Schedule

	Floor	4" Base Coving 3/8-inch minimum radius	Walls	Ceiling
Food Preparation (Kitchen)	<i>Sealed smooth concrete, ceramic tile or quarry tile</i>	<i>Continuous with floor, up wall 4" with 3/8" ceramic cove</i>	<i>F.R.P. (Fiberglass reinforced plastic) smooth and washable</i>	<i>Smooth and washable non-fissured</i>
Restroom	<i>Ceramic tile; smooth sealed concrete</i>	<i>Continuous with floor up wall 4" with 3/8" ceramic cove</i>	<i>Water-resistant dry wall, 4' ceramic wainscot</i>	<i>Water resistant drywall; white enamel</i>
Cleaning Equipment/ Janitorial Sink	<i>Quarry tile; ceramic tile; smooth sealed concrete</i>	<i>Continuous with floor up wall 4" with 3/8" ceramic cove</i>		<i>Washable, non-absorbent</i>
Dressing Room(s)	<i>Ceramic tile; smooth sealed concrete commercial grade sheet vinyl</i>	<i>Continuous with floor up wall 4" with 3/8" ceramic cove</i>	<i>White enamel paint on drywall</i>	<i>Light colored enamel, painted</i>
Walk-In Box	<i>Prefabricated stainless steel</i>	<i>Prefabricated stainless steel wall, 3/8" radius sanitary cove</i>	<i>Prefabricated stainless steel</i>	<i>Prefabricated stainless steel</i>

Salad bar is covered on top and sides by an approved sneeze guard

Smooth concrete is sealed to be water resistant with a clear approved sealant

APPROVED TRAWLED ON EPOXY FLOORS

Quarry tile to be made in USA

Quarry tile base not acceptable on concrete floor



Division of Environmental Health

100 H Street - Suite 100 - Eureka, CA 95501
 Phone: 707-445-6215 - Toll Free: 800-963-9241
 Fax: 707-441-5699
 envhealth@co.humboldt.ca.us

HOT WATER DEMANDS FOR A FOOD FACILITY

Establishment _____

Address _____

Fill in Applicable Fixtures	# Units	x	GPH	=	Total GPH
3-Compartment Sink (" x " x ")	3 (basins)	x	_____	=	_____
Hand Sink	_____	x	_____	=	_____
Mop Sink	_____	x	_____	=	_____
Prep Sink	_____	x	_____	=	_____
Dishwasher	_____	x	_____	=	_____
Pre-Rinse Unit	_____	x	_____	=	_____
Other:	_____	x	_____	=	_____
Other:	_____	x	_____	=	_____
Other:	_____	x	_____	=	_____
Other:	_____	x	_____	=	_____
			Total GPH	=	_____

TOTAL GPH _____ x _____ % (See sizing requirements below) _____ = GPH Required

COMPUTING THE BTU INPUT (gas water heaters)

GPH required _____ x 60° rise x 11 = BTU input of water heater

FORMULA FOR ELECTRIC WATER HEATERS

GPH required _____ x 0.149 = _____ KW input

SIZING REQUIREMENTS FOR STORAGE WATER HEATERS (not instantaneous water heaters)

- Food facilities with multi service eating utensils, heavy use (serving 3 meals a day) 100% GPH required
- Food facilities with multi service eating utensils, moderate use 90% GPH required
- Food facilities with single-service eating utensils, or don't use utensils at all 80% GPH required

Food facilities that sell **only** prepackaged foods -- A water heater with a minimum storage capacity of 10 gallons must be provided.

HOURLY HOT WATER DEMAND TABLE

Utensil Sinks			
18" x 18"	14 gallons per compartment		
24" x 24"	25 gallons per compartment		
Custom sink sizes can be calculated using the following formula: Length (ft) x Width (ft) x Depth (ft) x 7.5 = gallons per compartment			
Bar Sinks		Hand Sinks	
6 gallons per compartment		5 gallons per sink	
Pre-Rinse Units		Clothes Washers	
Hand spray type	45 gallons	9 and 12 lb Washers	45 gallons
Other type	Refer to manufacturer's specifications for the equipment.	16 lb Washers	60 gallons
Food Preparation Sinks		Employee Shower	
5 gallons per sink		20 gallons per shower	
Janitorial Sinks & Garbage Can Wash Facilities		Other Fixtures That Use Hot Water	
15 gallons per sink or facility		Refer to manufacturer's specifications for the equipment or NSF® listing.	

INSTANTANEOUS WATER HEATERS

Instantaneous water heaters must be sized to provide hot water of at least 120°F and at a rate of at least 2 GPM to each sink (hand sinks must receive at least ½ GPM). NSF listings are used to determine the minimum GPM hot water demand for automatic dishwashers.

For additional information on sizing and installation of water heaters, see Guidelines for Sizing Water Heaters available at the Division of Environmental Health.



Division of Environmental Health

100 H Street - Suite 100 - Eureka, CA 95501

Phone: 707-445-6215 - Toll Free: 800-963-9241

Fax: 707-441-5699

envhealth@co.humboldt.ca.us

GUIDELINES FOR FLOORING IN A FOOD FACILITY

When installing a new floor or replacing an existing floor, contact the Humboldt County Division of Environmental Health (DEH) to assure the floor and base meet the current requirements.

The California Retail Food Code (CalCode) §114268 provides the following:

(a) Except in sales areas, dining areas, and serving areas, the floor surfaces in all areas in which food is prepared, prepackaged, or stored, where any utensil is washed, where refuse or garbage is stored, where janitorial facilities are located in all toilet and handwashing areas, except with respect to areas relating to guestroom accommodations and the private accommodations of owners and operators in restricted food service facilities, and in employee change and storage areas shall be smooth and of durable construction and nonabsorbent material that is easily cleanable.

(b) Floor surfaces shall be coved at the juncture of the floor and wall with a 3/8 inch minimum radius coving and shall extend up the wall at least 4 inches, except in areas where food is stored only in unopened bottles, cans, cartons, sacks, or other original shipping containers.

Floor materials used in retail food facilities must be of smooth and durable construction, of non-absorbent materials, and must be provided in the following areas:

- Where food is prepared, packaged, or stored
- Where any utensil is washed
- Where refuse or garbage is stored
- Where janitorial facilities are located
- In all toilet and handwashing areas
- At unpackaged customer self-service food and beverage areas
- At wait stations
- In employee change and storage areas

A sample of all proposed flooring and coving material must be submitted to DEH for review prior to installation. The following describes floor types that will meet the CalCode requirements cited above:

- **In kitchens, storage areas, and other food preparation or service areas:**
 1. Quarry tile with a 4-inch minimum quarry tile coved base. Epoxy grout is recommended.
 2. Troweled-on epoxy floor (not paint) with a 4-inch minimum self-coved base.
 3. 100% homogeneous vinyl flooring, recommended by the manufacturer for use in commercial kitchens. The floor must have heat-welded seams and a 4-inch minimum self-coved base.

- **For walk-in refrigerators and freezers:**

1. Metal floor and coved base installed as part of the NSF-approved (or equivalent) walk-in refer unit.
2. Quarry tile with a coved base supplied by the walk-in refer manufacturer. Epoxy grout is recommended. The coved base supplied by the walk-in refer manufacturer should be used on the outside of the refrigerator if it is located within the kitchen.
3. Seamless troweled-on epoxy (not paint) with a coved base supplied by the refer unit manufacturer.
4. Smooth, sealed concrete with 4-inch coved concrete base or a coved base supplied by the walk-in refer manufacturer.

- **Regarding floor drains:** Upon new construction or extensive remodeling, floor drains shall be installed as follows.

1. In floors that are water-flushed for cleaning.
2. In areas where pressure spray methods for cleaning equipment are used.

In restrooms, floor drains are recommended, but not required.

Sealed Concrete

Generally, sealed concrete is appropriate for walk-ins, dining areas, and rear storage areas. If sealed concrete is proposed, check the manufacturer's specifications and recommendations. Most sealers should be reapplied every six months.

Flooring Standard:

The finished surface shall be smooth, easily cleanable, and sealed to be impervious to water, grease, and acid.

Installation:

1. The floor coating shall be of a smooth, single-pour variety.
2. All flooring shall be continuous up the walls, partitions, and cabinetry, a minimum of four (4) inches, forming a 3/8-inch-minimum-radius cove base.
3. The floor shall be sealed with a USDA approved, 2-part epoxy-catalyzed water-based epoxy concrete floor sealer.
4. Concrete floor areas with pitted, chipped, or rough surface areas, or open seams, shall be repaired prior to installation of concrete sealer.

Examples of Acceptable Concrete Sealers

- Ameritone Paint Corporation, Devoe Tru-Glaz WB (213) 639-6791, 128XX Semi-Gloss Coating, 129XX High-Gloss Coating
- Pega-Cote 9200 Water-Extended Epoxy Coating 1-909-982-5556
- Pratt & Lambert TECHGARD Water-Borne Epoxy 1-800-441-4750
- Rust-Oleum Corporation, Rust-Oleum 6010 1-800-323-3584
- Select Products Company, Select Epoxy-Kote WB-88 1-714-429-0800

If you have further questions, contact DEH at 707-445-6215 or Fax 707-441-5699